

BILL OF MATERIAL

MAINMARK	SUBMARK	QTY	SECTION	LENGTH	REMARKS	PC/LN
			PIT LADDER			
-		2	FB 1/2 x 2 1/2	8'-6"	SIDE BARS	
-		2	L 3 x 3 x 1/4	3		
-		4	FB 1/2 x 2 1/2	8 1/2"	(BENT)	
-		8	3/4" BAR	1'-6 3/4"	W/ ABRASIVE COAT	
			BOLTS			
-		4	3/4" A325	2	HEX HEAD	
-		4	1/2" WEDGE ANCH	3 3/4"		
-		2	1/2" LAG BOLT	3		

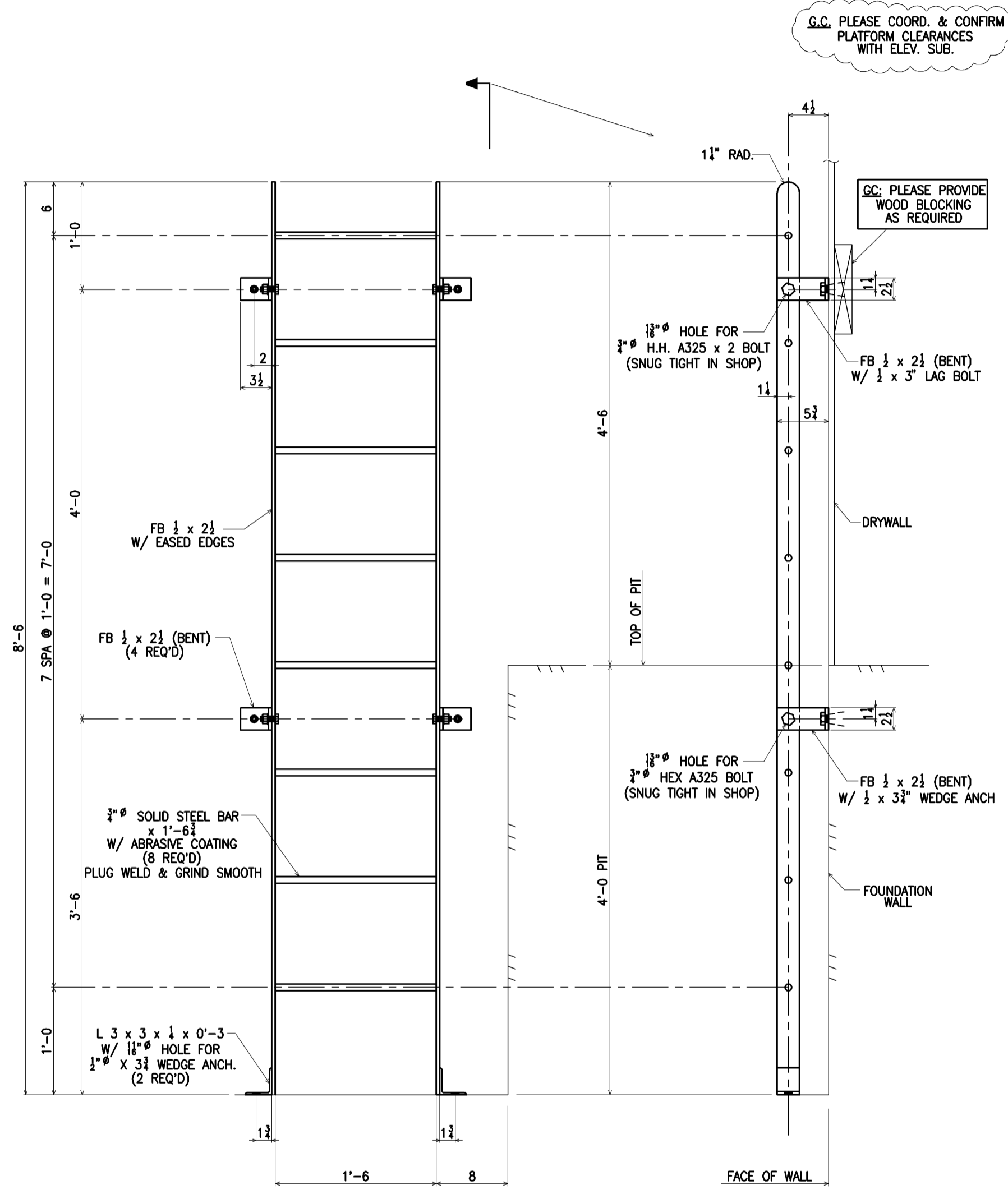

G.C. PLEASE COORD. & CONFIRM PLATFORM CLEARANCES WITH ELEV. SUB.

G.C. PLEASE PROVIDE WOOD BLOCKING AS REQUIRED

**SHOP NOTE:**  
 1.) ALL MATERIAL ON THIS DRAWING TO BE GALVANIZED.  
 2.) ALL WELDED MATERIAL TO BE SEAL WELDED FOR GALVANIZING.  
 3.) PROVIDE WEEP HOLES FOR GALVANIZING.

**ELEVATOR DWG'S**  
 ME13 THRU ME15

REF. DWGS A100, A104, A504

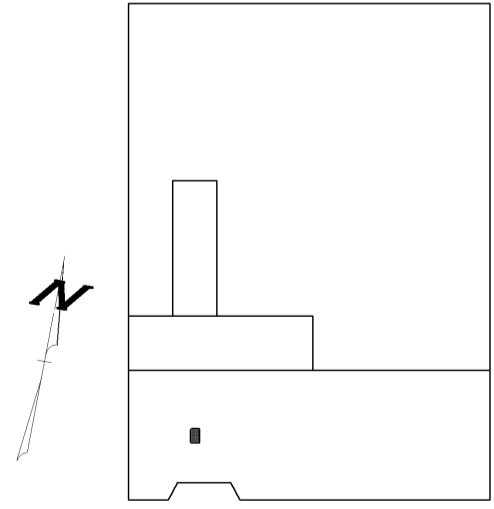

KEY PLAN

This drawing is the property of UNITED STEEL INC. and may not be reproduced or copied in whole or in part without its permission.



QUALITY CERTIFIED  
 CATEGORY I & II  
 BY THE AMERICAN INSTITUTE  
 OF STEEL CONSTRUCTION, INC.

**UNITED STEEL, INC.**  
 FABRICATORS & ERECTORS  
 164 SCHOOL STREET  
 EAST HARTFORD, CT 06108  
 FAX 860-289-2908

ITEM NO.	4	DESCRIPTION	ELEVATOR PIT LADDER	REMARKS	
SHOP BOLTS	1/2" A325	HOLES	3/8"	ALL MATERIALS TO BE ASTM-A36 UN.	
SHOP PAINT	NONE	SURFACE PREP	SSPC-SP2	DRY MILL THICK.	
MASONRY ANCHORS		ALL WELDS TO BE MADE WITH ELECTRODES SERIES E70XX-LH			
PROJECT	HEXAGON METROLOGY FACILITY NORTH KINGSTOWN, RI				
DRAWN BY	ARS 05-65	DATE	10/25/05	CHECKED BY	CH
				DATE	11/9/05
JOB NO.	5063	SHEET NO.	ME13		