

BILL OF MATERIAL

MAINMARK	SUBMARK	QTY	SECTION	LENGTH	REMARKS	PC/LN
RAILING						
-	LN.FT.	11 <sup>0</sup> SCH. 40 PIPE	46'-0"	1 <sup>1</sup> / <sub>2</sub> " O.D. (RAILS)		
-	LN.FT.	11 <sup>0</sup> SCH. 80 PIPE	21'-0"	1 <sup>1</sup> / <sub>2</sub> " O.D. (POSTS)		
-	6	WALL BRACKETS	-	J.BLUM #626		
-	ONE	3" SQ. BAR	1'-0"	BENT		
E-Z SLEEVES						
-	5	E-Z SLEEVES				
FIELD BOLTS						
-	6	3/4" x 3 H.H. FULL THRD BOLT				
-	6	3/8" DBL EXP. SHIELD				

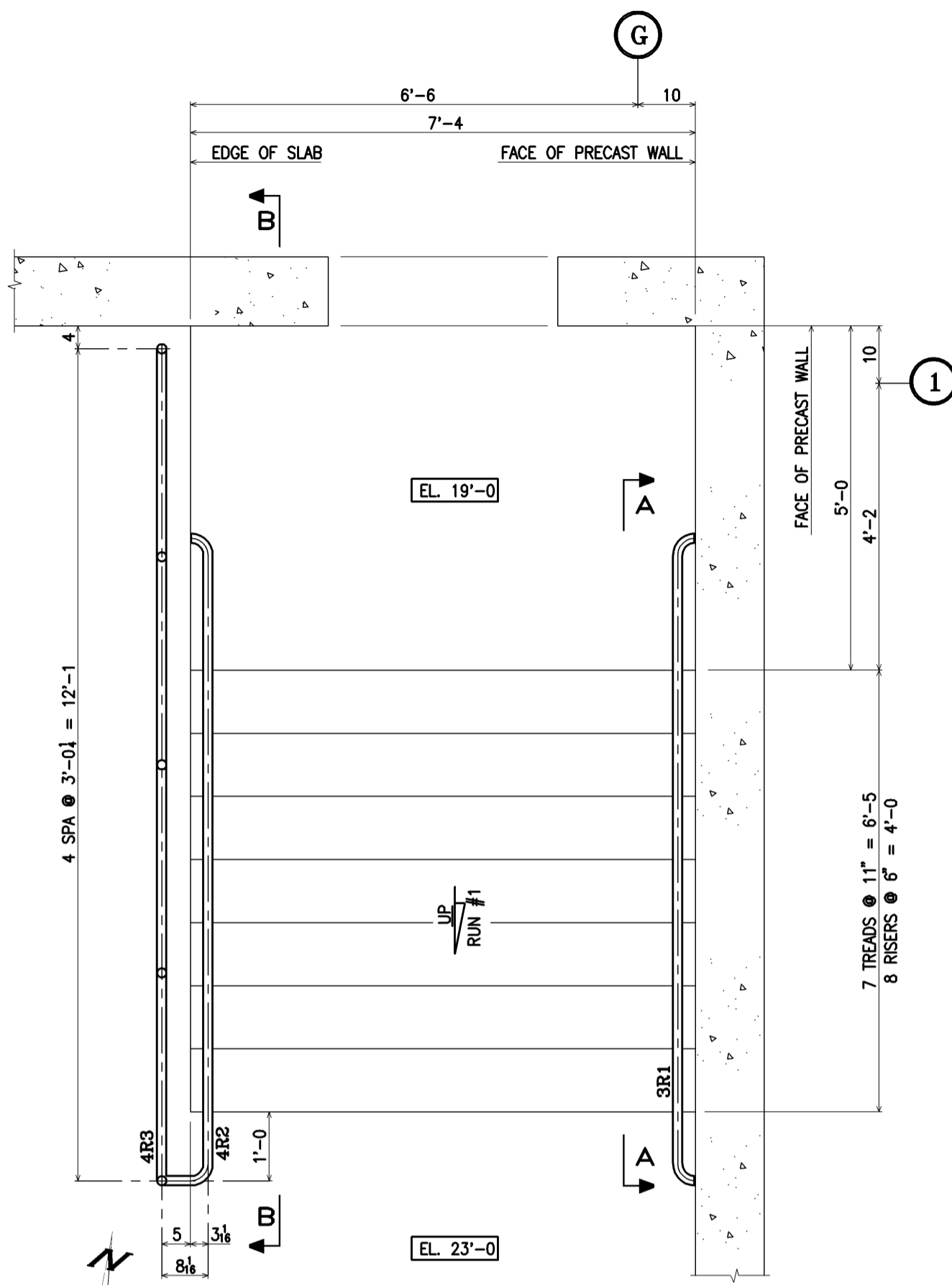

RAILING PLAN FOR STAIR #4  
(SCALE = 3/4")

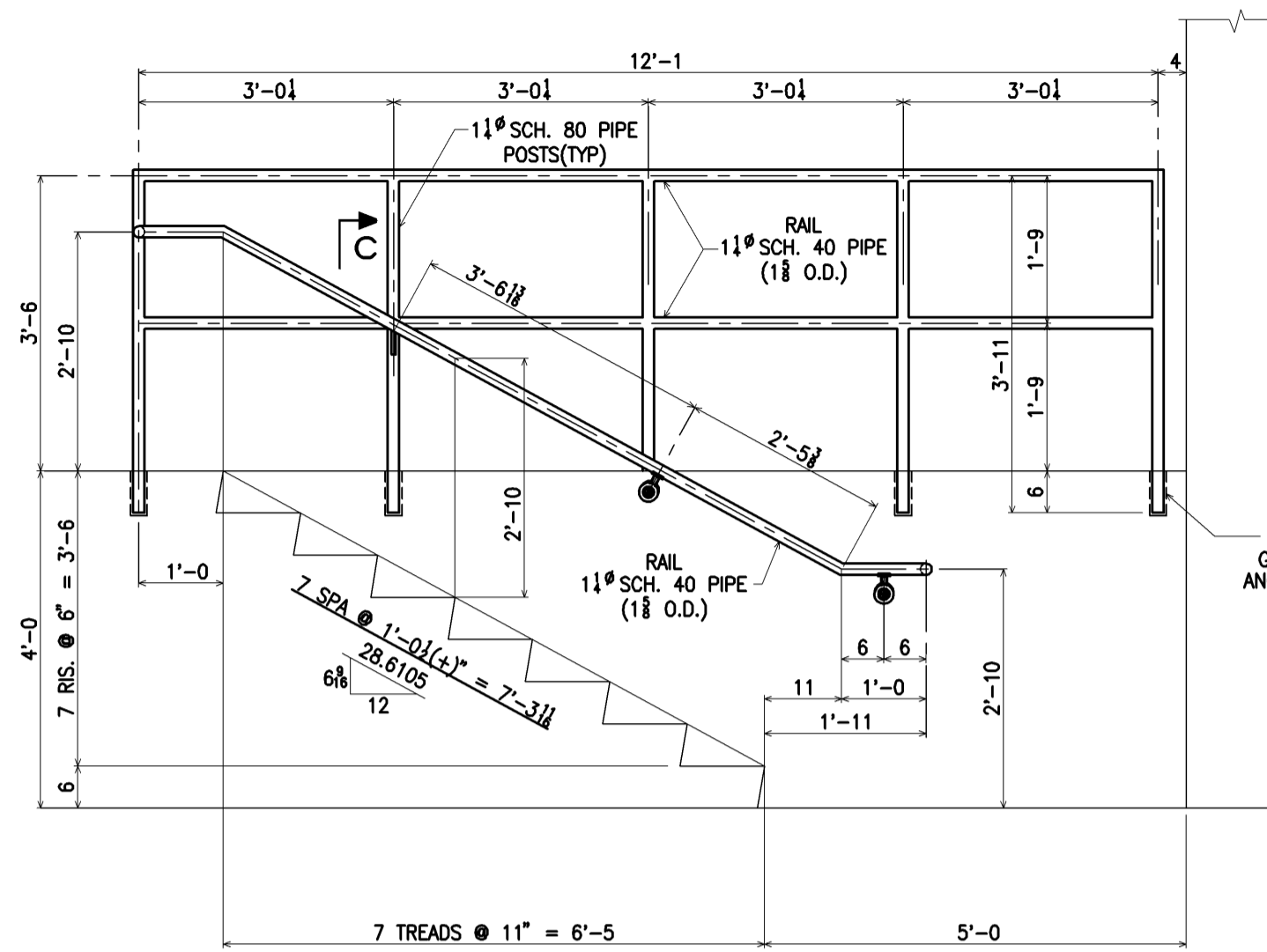

SECTION "B-B"  
(SCALE = 3/4")

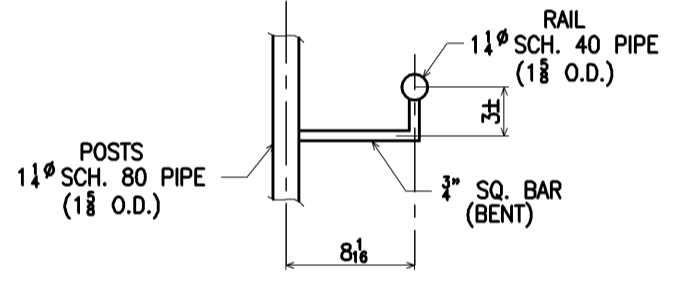

SECTION "C"  
(SCALE = 1 1/2")

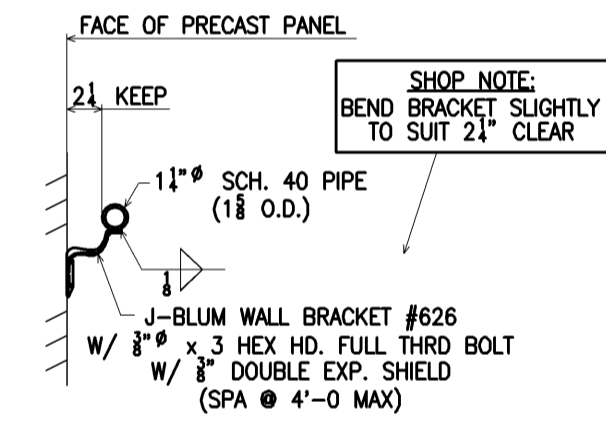

TYP. HANDRAIL TO WALL CONN.

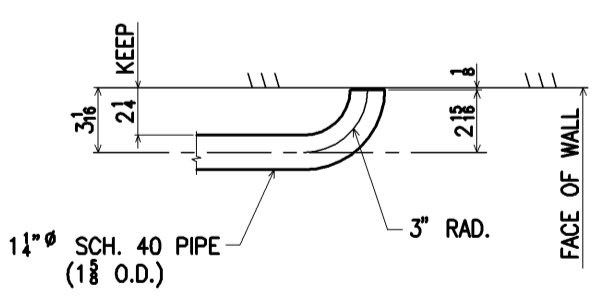

TYP. HANDRAIL TO WALL RETURN

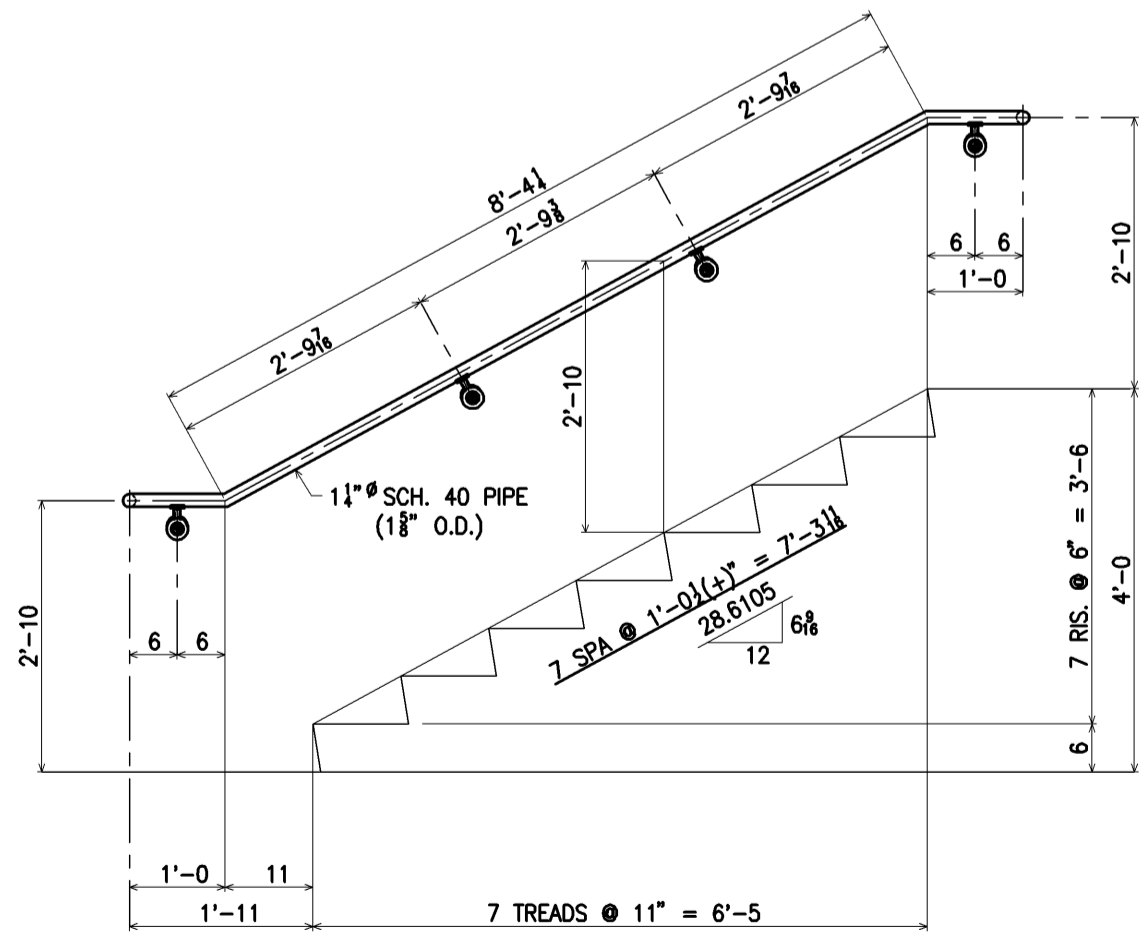

SECTION "A-A"  
(SCALE = 3/4")

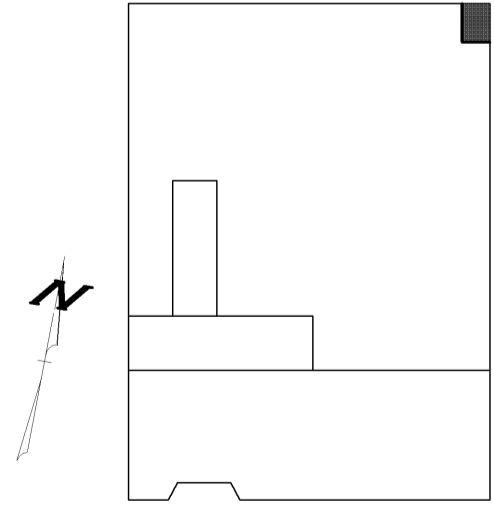

KEY PLAN

This drawing is the property of UNITED STEEL INC. and may not be reproduced or copied in whole or in part without its permission.

GENERAL NOTES:  
1. MATERIAL GRADES (NOT LISTED IN TITLE BLOCK)  
- PIPE MATERIAL ~ ASTM A53 GR. B

REF. DWGS A100, A105, S202, A503

ITEM NO.	DESCRIPTION	REMARKS
2B	STAIR #4 RAILS	

UNITED STEEL, INC.  
FABRICATORS & ERECTORS  
164 SCHOOL STREET  
860-289-2323

STRUCTURAL STEEL & MISCELLANEOUS METALS  
EAST HARTFORD, CT 06108  
FAX 860-289-2908

PROJECT: **HEXAGON METROLOGY FACILITY**  
**NORTH KINGSTOWN, RI**

DRAWN BY: **ARS 05-65** DATE: **10/25/05** CHECKED BY: **CH** DATE: **11/9/05**

JOB NO.: **5063** SHEET NO.: **ME12**



QUALITY CERTIFIED  
CATEGORY I & II  
BY THE AMERICAN INSTITUTE  
OF STEEL CONSTRUCTION, INC.

△	SHOP BOLTS	1 1/2" A325	HOLES	1 1/8"	ALL MATERIALS TO BE ASTM-A36 UN.
△	SHOP PAINT	1 S/C STD. PRIMER	SURFACE PREP	SSPC-SP2	DRY MILL THICK.
△	MASONRY ANCHORS				ALL WELDS TO BE MADE WITH ELECTRODES SERIES E70XX-LH